

Errors and Warnings



Auto-Off

From measurement mode, press and hold the ON/OFF button. The LCD will show "OFF", "CAL" followed by "d08" (default setting, 8 minutes). Release the ON/OFF button. A single press on the ON/OFF button will change the auto-off timer to "d60" (60 minutes). To disable the auto-off feature press the ON/OFF button again, LCD will show "d--". Press and hold to exit.



Clear Calibration

To clear the user calibration and restore the tester to factory default. From calibration mode, press and hold the ON/OFF button, the LCD will show "CLr".



"Err" Message

In calibration mode, if the probe is in the correct buffer solution and the "Err" message is displayed, the probe should be cleaned. Soak the probe in cleaning solution for 20 minutes. Rinse with water and hydrate electrode in storage solution for a minimum of 30 minutes before calibrating.



Battery Indicator

When the battery level is low, the tag on the LCD will blink. When the battery is depleted the "Err" message is displayed and the tester is powered off.

Care & Maintenance

Please read the information below, to ensure the highest possible accuracy:

- Fresh buffer should be used for each calibration, once the sachets are opened the buffer value can change over time.
- For improved accuracy a two-point calibration is recommended.
- If the electrode is slow or sluggish, soak it in cleaning solution for 20 minutes. Rinse with water and hydrate the electrode in storage solution for a minimum of 30 minutes before calibrating.
- If measurements are taken successively, rinse the probe thoroughly in distilled or deionized water to eliminate cross-contamination.
- When not in use, add a few drops of storage solution to the protective cap to keep the glass tip and the junction hydrated. If storage solution is not available, pH 4.01 or pH 7.01 buffer can be used. Never store the probe in distilled or deionized water.

Note: Never immerse the tester over the maximum immersion level.

Battery Replacement

1. Use an appropriately sized, slotted screwdriver to press then twist counter-clockwise to open the battery compartment.
2. Set the battery cover aside.
3. Insert the new battery with + side facing up.
4. Align the mark on the cover (⊙) with the open lock icon (⊖) on the case.
5. Press then rotate the screwdriver clockwise until the mark on the cover aligns with the closed lock icon (⊕).

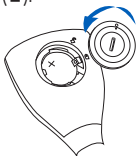

Note: Only use the battery type specified in the manual.

Old batteries should be disposed in accordance with local regulations.

Accessories

pH Buffer Solution

HI70004P	pH 4.01 buffer solution, 20 mL sachet (25 pcs.)
HI70007P	pH 7.01 buffer solution, 20 mL sachet (25 pcs.)
HI77400P	pH 4.01 & 7.01 buffer solution, 20 mL sachet (10 pcs., 5 each)

Electrode Cleaning Solution

HI700601P	General purpose cleaning solution, 20 mL sachet (25 pcs.)
HI700641P	Cleaning and disinfection solution for dairy products, 20 mL sachet (25 pcs.)
HI700642P	Cleaning solution for cheese deposits, 20 mL sachet (25 pcs.)

Electrode Storage Solution

HI70300L	Electrode storage solution, 500 mL
HI70300M	Electrode storage solution, 230 mL
HI9072	Electrode storage solution, 13 mL dropper

Certification

All Hanna® instruments conform to the CE European Directives.



Disposal of Electrical & Electronic Equipment. The product should not be treated as household waste. Instead, hand it over to the appropriate collection point for the recycling of electrical and electronic equipment, which will conserve natural resources. **Disposal of waste batteries.** This product contains battery, do not dispose of it with other household waste. Hand it over to the appropriate collection point for recycling. **Ensuring proper product and battery disposal** prevents potential negative consequences for the environment and human health. For more information, contact your city, your local household waste disposal service, or the place of purchase.

Recommendations for Users

Before using this tester, make sure that it is entirely suitable for your specific application and for the environment in which it is used. Avoid touching the electrode at all times. Any variation introduced by the user to the supplied equipment may degrade the tester's performance. For your and the tester's safety do not use or store the tester in hazardous environments.

Warranty

HI981032 is warranted for a period of one year against defects in workmanship and materials when used for its intended purpose and maintained according to instructions. This warranty is limited to repair or replacement free of charge. Damage due to accidents, misuse, tampering, or lack of prescribed maintenance is not covered. If service is required, contact your local Hanna Instruments® office. If under warranty, report the model number, date of purchase, serial number, and the nature of the problem. If the repair is not covered by the warranty, you will be notified of the charges incurred. If the instrument is to be returned to Hanna Instruments, first obtain a Returned Goods Authorization (RGA) number from the Technical Service department and then send it with shipping costs prepaid. When shipping any instrument, make sure it is properly packaged for complete protection.

Hanna Instruments reserves the right to modify the design, construction, or appearance of its products without advance notice.

All rights are reserved. Reproduction in whole or in part is prohibited without the copyright owner's written consent, Hanna Instruments Inc., Woonsocket, Rhode Island, 02895, USA.

IST981032 03/26

INSTRUCTION MANUAL

HI981032 Cheese pH Tester



Foodcare

HANNA
instruments

Dear Customer,

Thank you for choosing a Hanna Instruments® product. Please read this instruction manual carefully before using the tester. For more information about Hanna Instruments and our products, visit www.hannainst.com or e-mail us at sales@hannainst.com. For technical support, contact your local Hanna Instruments office or e-mail us at tech@hannainst.com.

Preliminary Examination

Remove the tester and accessories from the packing material and examine them carefully. For further assistance, please contact your local Hanna Instruments office or email us at tech@hannainst.com.

Each HI981032 is delivered in a cardboard box and is supplied with:

- HI70004 pH 4.01 buffer solution, 20 mL sachet (2 pcs.)
- HI70007 pH 7.01 buffer solution, 20 mL sachet (2 pcs.)
- HI700642 Cleaning solution for cheese deposits, 20 mL sachet (2 pcs.)
- HI9072 Electrode storage solution, 13 mL dropper
- CR2032 3V Lithium-ion battery
- Battery safety insert
- Instrument quality certificate and instruction manual

Note: Save all packing material until you are sure that the tester works correctly. Any damaged or defective item must be returned in its original packing material with the supplied accessories.

General Description & Intended Use

The HI981032 Cheese pH Tester is designed to measure and monitor the pH of cheese during the main processing steps of cheese manufacturing. It is the user's obligation to ensure that cheese samples meet the food-hygiene and Hazard Analysis Critical Control Point (HACCP) regulations.

It features a single button operation system and is easy to use. It has a compact and waterproof casing and automatic pH calibration at one or two points.

All readings are automatically compensated for temperature variations with a built-in temperature sensor.

The conical tip allows measurements to be taken directly in solid or semisolid samples.

Probe Features

Conical Tip

The conical tip allows for easy penetration into whey and semisolids which is needed when wanting to take a direct measurement in cheese.



pH probe

Specialized Glass Formulation

Specialized low temperature (LT) pH glass ensures fast stabilization and accurate results at lower temperatures.

Open Junction Reference

The open junction design consists of a solid gel interface between the sample and internal Ag/AgCl reference. This interface prevents silver from entering the sample and makes it impermeable to clogging, resulting in fast response and stable reading.

Polyvinylidene Fluoride (PVDF) Body

PVDF is a food-grade plastic that is resistant to most chemicals and solvents, including sodium hypochlorite, it is also resistant to fungal growth. It has high abrasion resistance, mechanical strength, and resistance to ultraviolet.

Specifications

Range	0.00 to 12.00 pH
Resolution	0.01 pH
Accuracy	±0.05 pH
Calibration	Automatic, one or two-point
Temperature compensation	Automatic, 0 to 50 °C
Electrode	Built-in probe for specific application
Battery type	CR2032 Lithium-ion (included)
Battery life	Approximately 800 hours of continuous use
Auto-off	8 minutes, 60 minutes or disabled
Environment	0 to 50 °C (32 to 122 °F); RH 95% max
Dimensions	50 x 129 x 21 mm (2 x 5.1 x 0.9")
Weight	42 g (1.48 oz.)

Functional Description & LCD Display

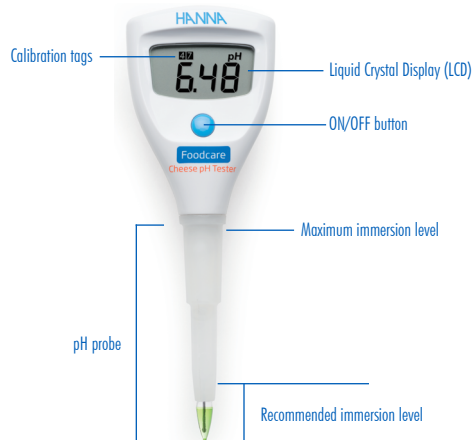

Preparation

- Remove the protective cap. Do not be alarmed if salt deposits are present. Rinse the probe with water and blot dry.
- If the glass and/or junction are dry soak the electrode (bottom 4 cm / 1.5") in storage solution for a minimum of 30 minutes. Rinse with water and blot dry.
- Calibrate the electrode before using. For best results it is recommended to recalibrate periodically.

Storage

- To ensure a quick response, the glass tip and junction should be kept moist.
- Replace the protective cap with a few drops of storage solution when not in use. Do not store the electrode in distilled or deionized water.

Operation

Press the ON/OFF button to turn the meter on. The tester displays all LCD segments for a few seconds. The tester will enter measurement mode, the current reading and calibrated buffers will be shown.

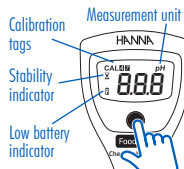

Calibration

From measurement mode, press and hold the ON/OFF button until "CAL" is displayed.

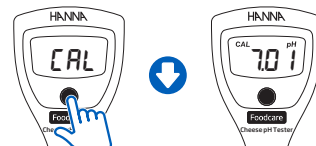

- A** For one or two-point calibration using pH 7.01 buffer solution, follow procedure A.
- B** For one-point calibration using pH 4.01 buffer solution, follow procedure B.

Note: It is recommended to calibrate the electrode with buffers at the temperature it will be used at.

A One or Two-Point Calibration with pH 7.01

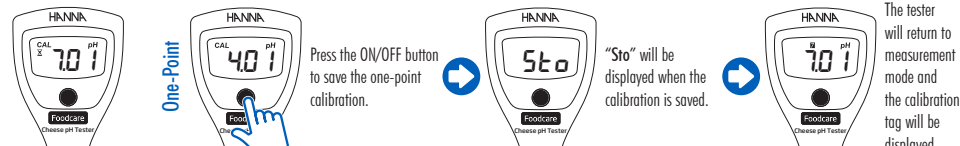

When "7.01" is displayed, place the tip of the electrode in pH 7.01 buffer.

When the reading is stable, the stability icon will disappear. When "4.01" is displayed, follow the procedure to the right for a one or two-point calibration.

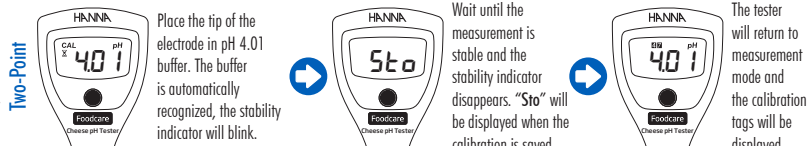

B One-Point Calibration with pH 4.01

