



Method(e):

0301

50–600 mg/L O<sub>2</sub>

20–80 %:

50

160

490

600 mg/L O<sub>2</sub>



REF 985 030

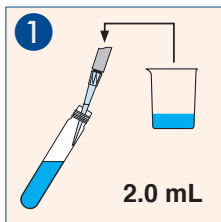

Probe / Sample  
Échant. / Muestra

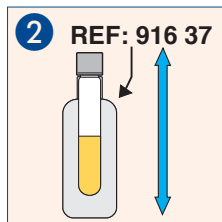

Schütteln / Shake  
Agiter / Agitar

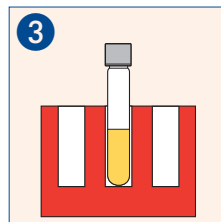

160 °C / 30 min  
148 °C / 2 h

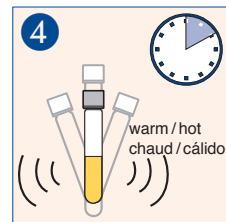

Schütteln / Shake  
Agiter / Agitar

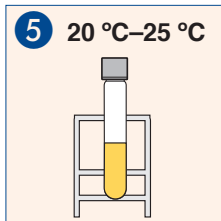

Abkühlen / Cool  
Refridir / Enfriar

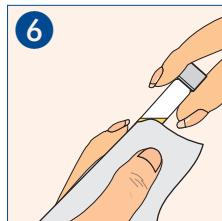

Säubern / Clean  
Nettoyer / Limpiar

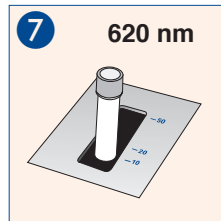

Messen / Measure  
Mesurer / Medir