

VISOCOLOR[®] ECO

VISOCOLOR[®] ECO

Testanleitungen

Test instructions

Instructions des tests

Instrucciones de los tests



für Kompaktphotometer PF-3

for compact photometer PF-3

pour photomètre compact PF-3

para fotómetro compacto PF-3

MACHEREY-NAGEL

www.mn-net.com



visicolor® ECO Alkalinität TA Alkalinity TA/Alcalinité TA/Alcalinidad TA

450/590 nm

Method(e) / Método

5041	0.3–14 °d
5042	0.10–5.00 mmol/L H ⁺
5043	0.4–17.5 °e
5044	0.5–25.0 °f
5045	5–250 mg/L CaCO ₃

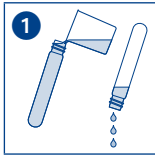
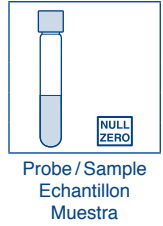

1
Küvette spülen
Rinse test tube
Rincer l'éprouvette
Lavar el tubo

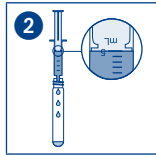

2 5 mL Probe
Sample
Echantillon
Muestra

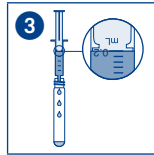

3 200 µL TA-1

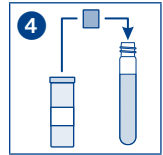

4 1 NANOFIX TA-2



5
Schütteln
Shake
Agiter
Agitar



6
Säubern
Clean
Nettoyer
Limpiar



7 2'00 min



8
Messung
Measurement
Mesure
Medición

Umrechnungstabelle/Conversion table/ Tableau de conversion/Tabla de conversión

°d	°e	°f	mg/L CaCO ₃	mmol/L H ⁺	gpg
1	1.3	1.8	18	0.36	1
2	2.5	3.6	36	0.72	2
3	3.8	5.4	54	1.08	3
4	5.0	7.1	71	1.42	4
5	6.3	8.9	89	1.78	5
6	7.5	10.7	107	2.14	6
7	8.8	12.5	125	2.50	7
8	10.0	14.3	143	2.86	8
9	11.3	16.1	161	3.22	9
10	12.5	17.8	178	3.56	10

Messtoleranzen:
Measuring tolerances:
Tolérance de mesure :
Tolerancia de la medición:
± 10 mg/L CaCO₃

Meerwasser
Sea water
Eau de mer
Agua de mar



visicolor[®] ECO Ammonium 3

Amonio

660 nm

Method(e) / Método

5081

0.1–2.0 mg/L NH₄-N

5082

0.1–2.5 mg/L NH₄⁺

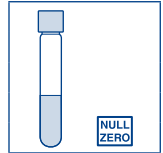

Probe / Sample
Echantillon
Muestra



1
Küvette spülen
Rinse test tube
Rincer l'éprouvette
Lavar el tubo

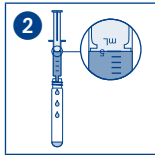

2
5 mL Probe
Sample
Echantillon
Muestra

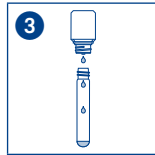

3
10 ∆ NH₄-1



4
Schütteln
Shake
Agiter
Agitar

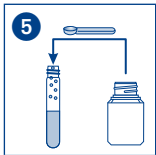

5
1 ∆ NH₄-2



6
Schütteln
Shake
Agiter
Agitar

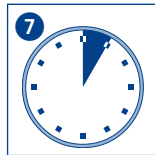

7
5'00 min

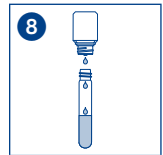

8
4 ∆ NH₄-3



9
Schütteln
Shake
Agiter
Agitar



10
Säubern
Clean
Nettoyer
Limpiar

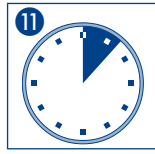

11
7'00 min

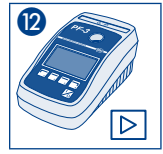

12
Messung
Measurement
Mesure
Medición

Messtoleranzen:
Measuring tolerances:
Tolérance de mesure :
Tolerancia de la medición:
± 0.1 mg/L NH₄⁺

Meerwasser
Sea water
Eau de mer
Agua de mar



visicolor® ECO Brom (frei)
Bromine (free)/Brome (libre)/Bromo (libre)

530 nm

Method(e) / Método

5111

0.10–13.00 mg/L Br₂

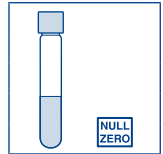

Probe / Sample
 Echantillon
 Muestra



1
 Küvette spülen
 Rinse test tube
 Rincer l'éprouvette
 Lavar el tubo

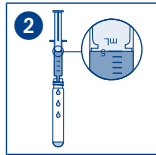

2
 5 mL Probe
 Sample
 Echantillon
 Muestra

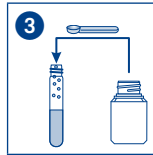

3
 1 Br₂-1



4
 20 s Schütteln
 Shake
 Agiter
 Agitar



5
 Säubern
 Clean
 Nettoyer
 Limpiar

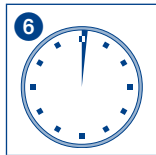

6
 1'00 min



7
 Messung
 Measurement
 Mesure
 Medición

Messtoleranzen:
 Measuring tolerances:
 Tolérance de mesure :
 Tolerancia de la medición:
 ± 0.20 mg/L Br₂

Meerwasser
 Sea water
 Eau de mer
 Agua de mar



visicolor® ECO Brom (gesamt) Bromine (total) / Brome (total) / Bromo (total)

530 nm

Method(e) / Método

5112

0.10–13.00 mg/L Br₂

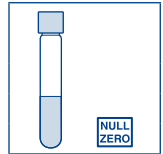

Probe / Sample
Echantillon
Muestra



1
Küvette spülen
Rinse test tube
Rincer l'éprouvette
Lavar el tubo

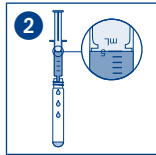

2
5 mL Probe
Sample
Echantillon
Muestra

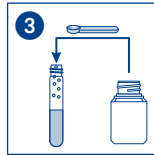

3
1 Br₂-1



4
20 s Schütteln
Shake
Agiter
Agitar

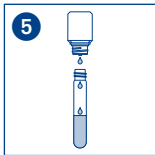

5
3 Br₂-2



6
Schütteln
Shake
Agiter
Agitar

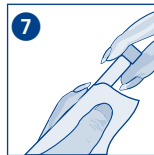

7
Säubern
Clean
Nettoyer
Limpiar

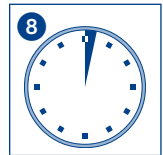

8
2'00 min



9
Messung
Measurement
Mesure
Medición

Messtoleranzen:
Measuring tolerances:
Tolérance de mesure :
Tolerancia de la medición:
± 0.20 mg/L Br₂

Meerwasser
Sea water
Eau de mer
Agua de mar



visicolor[®] ECO Brom (gebunden)

Bromine (combined)/Brome (combiné)/Bromo (ligado)

530 nm

Method(e) / Método

5111 + 5113

0.10–13.00 mg/L Br₂

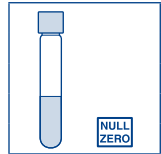

Probe / Sample
Echantillon
Muestra



1
Küvette spülen
Rinse test tube
Rincer l'éprouvette
Lavar el tubo

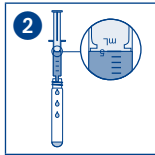

2
5 mL Probe
Sample
Echantillon
Muestra

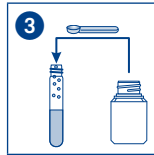

3
1 mL Br₂-1



4
20 s Schütteln
Shake
Agiter
Agitar



5
Säubern
Clean
Nettoyer
Limpiar

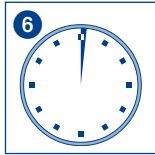

6
1'00 min



7
Messung
Measurement
Mesure
Medición



8
Method(e) 5113
Método 5113

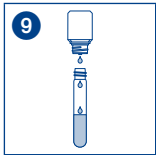

9
3 Δ Br₂-2



10
Schütteln
Shake
Agiter
Agitar

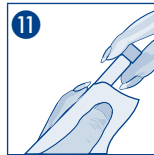

11
Säubern
Clean
Nettoyer
Limpiar

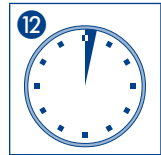

12
2'00 min



13
Messung
Measurement
Mesure
Medición

Messtoleranzen:
Measuring tolerances:
Tolérance de mesure :
Tolerancia de la medición:
± 0.20 mg/L Br₂

Meerwasser
Sea water
Eau de mer
Agua de mar



visicolor® ECO Chlor 2 (frei)**Chlorine (free)/Chlore (libre)/Cloro (libre)****530 nm**

Method(e) / Método

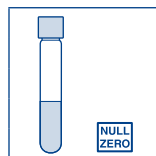
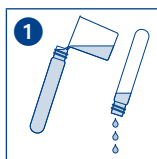
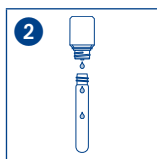
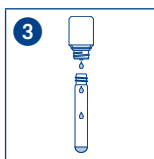
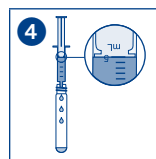
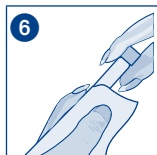
5151/51610.05–2.00 mg/L Cl₂Probe / Sample
Echantillon
Muestra**1**
Küvette spülen
Rinse test tube
Rincer l'éprouvette
Lavar el tubo**2** 3 ∆ Cl₂-1**3** 3 ∆ Cl₂-2**4**
5 mL Probe
Sample
Echantillon
Muestra**5**
Schütteln
Shake
Agiter
Agitar**6**
Säubern
Clean
Nettoyer
Limpiar**7**
Messung
Measurement
Mesure
MediciónMesstoleranzen:
Measuring tolerances:
Tolérance de mesure :
Tolerancia de la medición:
± 0.10 mg/L Cl₂Meerwasser
Sea water
Eau de mer
Agua de mar

visicolor® ECO Chlor 2 (gesamt) Chlorine (total) / Chlore (total) / Cloro (total)

530 nm

Method(e) / Método

5152

0.05–2.00 mg/L Cl₂

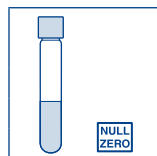

Probe / Sample
Echantillon
Muestra



1
Küvette spülen
Rinse test tube
Rincer l'éprouvette
Lavar el tubo

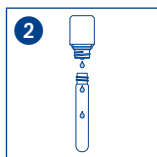

2
3 ∆ Cl₂-1

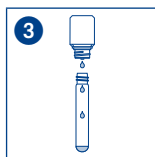

3
3 ∆ Cl₂-2

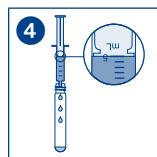

4
5 mL Probe
Sample
Echantillon
Muestra



5
Schütteln
Shake
Agiter
Agitar

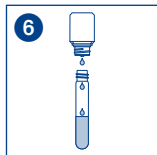

6
3 ∆ Cl₂-3



7
Schütteln
Shake
Agiter
Agitar

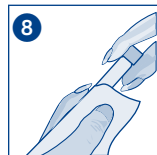

8
Säubern
Clean
Nettoyer
Limpiar



9
2'00 min



10
Messung
Measurement
Mesure
Medición

Messtoleranzen:
Measuring tolerances:
Tolérance de mesure :
Tolerancia de la medición:
± 0.10 mg/L Cl₂

Meerwasser
Sea water
Eau de mer
Agua de mar



visicolor[®] ECO Chlor 2 (gebunden) Chlorine (combined)/Chlore (combiné)/Cloro (ligado)

530 nm

Method(e) / Método

5151 + 5153

0.05–2.00 mg/L Cl₂

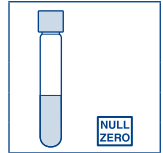

Probe / Sample
Echantillon
Muestra

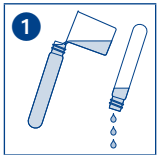

1
Küvette spülen
Rinse test tube
Rincer l'éprouvette
Lavar el tubo

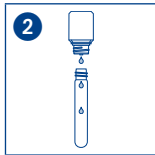

2 3 Δ Cl₂-1

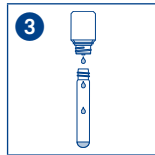

3 3 Δ Cl₂-2

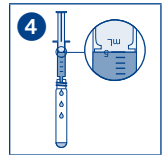

4
5 mL Probe
Sample
Echantillon
Muestra



5
Schütteln
Shake
Agiter
Agitar

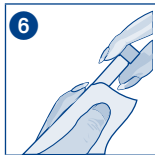

6
Säubern
Clean
Nettoyer
Limpiar



7
Messung
Measurement
Mesure
Medición



Method(e) 5153
Método 5153

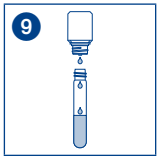

9 3 Δ Cl₂-3



10
Schütteln
Shake
Agiter
Agitar

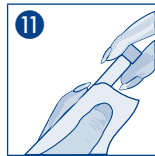

11
Säubern
Clean
Nettoyer
Limpiar



12
2'00 min



Messung
Measurement
Mesure
Medición

Messtoleranzen:
Measuring tolerances:
Tolérance de mesure :
Tolerancia de la medición:
± 0.10 mg/L Cl₂

Meerwasser
Sea water
Eau de mer
Agua de mar



visicolor[®] ECO Chlor 6 (frei)**Chlorine (free)/Chlore (libre)/Cloro (libre)****530 nm**

Method(e) / Método

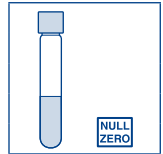
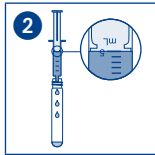
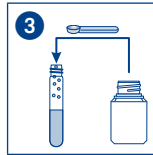
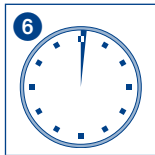
5171/51910.05–6.00 mg/L Cl₂Probe / Sample
Echantillon
Muestra**1**
Küvette spülen
Rinse test tube
Rincer l'éprouvette
Lavar el tubo**2**
5 mL Probe
Sample
Echantillon
Muestra**3**
1 Cl₂-1**4**
20 s Schütteln
Shake
Agiter
Agitar**5**
Säubern
Clean
Nettoyer
Limpiar**6**
1'00 min**7**
Messung
Measurement
Mesure
MediciónMesstoleranzen:
Measuring tolerances:
Tolérance de mesure :
Tolerancia de la medición:
± 0.10 mg/L Cl₂Meerwasser
Sea water
Eau de mer
Agua de mar

visicolor® ECO Chlor 6 (gesamt) Chlorine (total) / Chlore (total) / Cloro (total)

530 nm

Method(e) / Método

5172

0.05–6.00 mg/L Cl₂

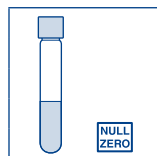

Probe / Sample
Echantillon
Muestra

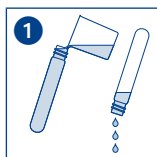

1
Küvette spülen
Rinse test tube
Rincer l'éprouvette
Lavar el tubo

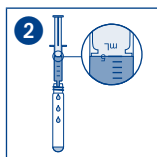

2
5 mL Probe
Sample
Echantillon
Muestra

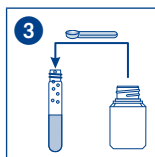

3
1 Cl₂-1



4
20 s Schütteln
Shake
Agiter
Agitar

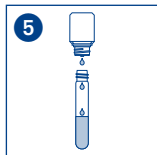

5
3 Cl₂-2



6
Schütteln
Shake
Agiter
Agitar

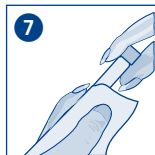

7
Säubern
Clean
Nettoyer
Limpiar



8
2'00 min



9
Messung
Measurement
Mesure
Medición

Messtoleranzen:
Measuring tolerances:
Tolérance de mesure :
Tolerancia de la medición:
± 0.10 mg/L Cl₂

Meerwasser
Sea water
Eau de mer
Agua de mar



visicolor[®] ECO Chlordioxid

Chlorine dioxide / Dioxyde de chlore / Cloro dióxido

530 nm

Method(e) / Método

5211

0.20–3.80 mg/L ClO₂

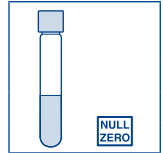

Probe / Sample
Echantillon
Muestra



1
Küvette spülen
Rinse test tube
Rincer l'éprouvette
Lavar el tubo

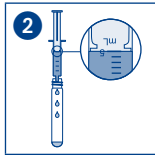

2 5 mL Probe
Sample
Echantillon
Muestra

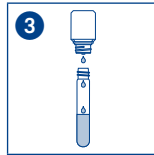

3 2 ∆ ClO₂-1



4
Schütteln
Shake
Agiter
Agitar



2'00 min

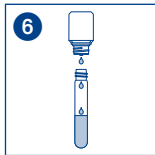

3 ∆ ClO₂-2



7
Schütteln
Shake
Agiter
Agitar

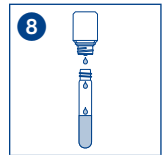

3 ∆ ClO₂-3



9
Schütteln
Shake
Agiter
Agitar

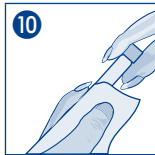

10
Säubern
Clean
Nettoyer
Limpiar



11
Messung
Measurement
Mesure
Medición

Messtoleranzen:
Measuring tolerances:
Tolérance de mesure :
Tolerancia de la medición:
± 0.20 mg/L ClO₂

Meerwasser
Sea water
Eau de mer
Agua de mar



visicolor[®] ECO Cyanursäure

Cyanuric acid / Acide cyanurique / Ácido cianúrico

450 nm

Method(e) / Método

5231

10–100 mg/L Cya

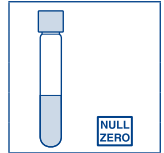

Probe / Sample
Echantillon
Muestra



1
Küvette spülen
Rinse test tube
Rincer l'éprouvette
Lavar el tubo

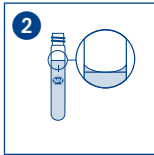

2 10 mL Probe
Sample
Echantillon
Muestra

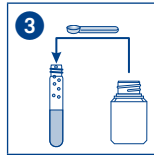

3 ½ Cya-1



4 15 s Schütteln
Shake
Agiter
Agitar

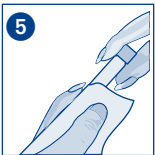

5
Säubern
Clean
Nettoyer
Limpiar

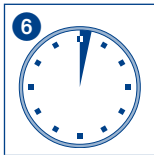

6 2'00 min



7
Messung
Measurement
Mesure
Medición

Messtoleranzen:
Measuring tolerances:
Tolérance de mesure :
Tolerancia de la medición:
± 10 mg/L Cya

Meerwasser
Sea water
Eau de mer
Agua de mar



visicolor[®] ECO Eisen 1

Iron / Fer / Hierro

530 nm

Method(e) / Método

5251

0.04–2.00 mg/L Fe

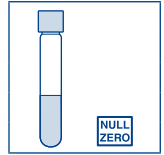

Probe / Sample
Echantillon
Muestra



1
Küvette spülen
Rinse test tube
Rincer l'éprouvette
Lavar el tubo

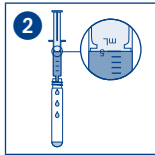

2
5 mL Probe
Sample
Echantillon
Muestra

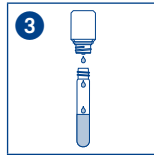

3
5 ∆ Fe-1



4
Schütteln
Shake
Agiter
Agitar



5
Säubern
Clean
Nettoyer
Limpiar



6
3'00 min



7
Messung
Measurement
Mesure
Medición

Messtoleranzen:
Measuring tolerances:
Tolérance de mesure :
Tolerancia de la medición:
± 0.04 mg/L Fe

Meerwasser
Sea water
Eau de mer
Agua de mar



visicolor[®] ECO Eisen 2

Iron / Fer / Hierro

530 nm

Method(e) / Método

5261

0.04–2.00 mg/L Fe

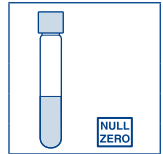

Probe / Sample
Echantillon
Muestra



1
Küvette spülen
Rinse test tube
Rincer l'éprouvette
Lavar el tubo

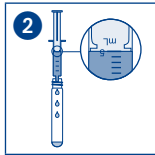

2
5 mL Probe
Sample
Echantillon
Muestra

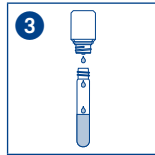

3
4 ⚡ Fe-1



4
Schütteln
Shake
Agiter
Agitar

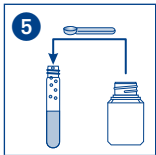

5
1 Fe-2



6
Schütteln
Shake
Agiter
Agitar



7
Säubern
Clean
Nettoyer
Limpiar

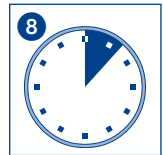

8
7'00 min



9
Messung
Measurement
Mesure
Medición

Messtoleranzen:
Measuring tolerances:
Tolérance de mesure :
Tolerancia de la medición:
± 0.04 mg/L Fe

Meerwasser
Sea water
Eau de mer
Agua de mar



visicolor[®] ECO Fluorid Fluoride / Fluorure / Fluoruro

590 nm

Method(e) / Método

5271

0.1–2.0 mg/L F⁻

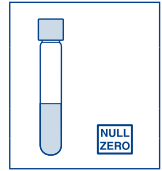

Nullwert / Blanc
value
Zéro / Cero

Nullwert / Blanc value / Zéro / Cero

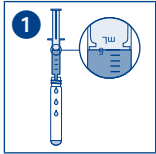

1
5 mL dest. Wasser
dist. water
d'eau distillée
agua dest.

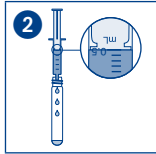

2
500 µL F-1



3
Schütteln
Shake
Agiter
Agitar

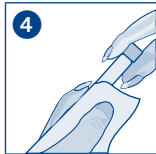

4
Säubern
Clean
Nettoyer
Limpiar



5
5'00 min



6
Nullwert
Blanc value
Zéro
Cero

Messwert / Sample / Echantillon / Muestra

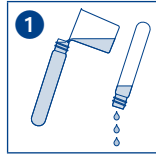

1
Küvette spülen
Rinse test tube
Rincer l'éprouvette
Lavar el tubo

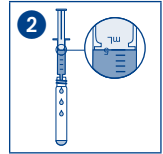

2
5 mL Probe
Sample
Echantillon
Muestra

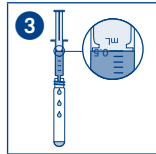

3
500 µL F-1



4
Schütteln
Shake
Agiter
Agitar



5
Säubern
Clean
Nettoyer
Limpiar

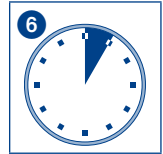

6
5'00 min



7
Messung
Measurement
Mesure
Medición

Messtoleranzen:
Measuring tolerances:
Tolérance de mesure :
Tolerancia de la medición:
± 0.1 mg/L F⁻

Meerwasser
Sea water
Eau de mer
Agua de mar



visicolor® ECO Kalium
Potassium/Potasio

660 nm

Method(e) / Método

5321

2–15 mg/L K⁺

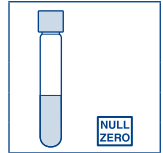

Probe / Sample
 Echantillon
 Muestra

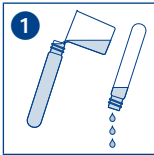

1
 Küvette spülen
 Rinse test tube
 Rincer l'éprouvette
 Lavar el tubo

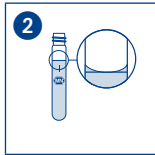

2 10 mL Probe
 Sample
 Echantillon
 Muestra

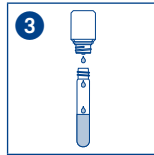

3 15 ∆ K-1



4
 Schütteln
 Shake
 Agiter
 Agitar

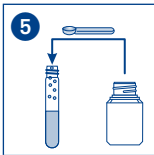

5 1 ∆ K-2



6 30 s Schütteln
 Shake
 Agiter
 Agitar

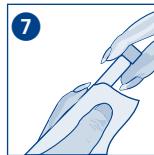

7
 Säubern
 Clean
 Nettoyer
 Limpiar



8
 Messung sofort
 Measurement immediately
 Mesure immédiatement
 Medición inmediatamente

Messtoleranzen:
 Measuring tolerances:
 Tolérance de mesure :
 Tolerancia de la medición:
 ± 1 mg/L K⁺

Meerwasser
 Sea water
 Eau de mer
 Agua de mar



visicolor[®] ECO Kieselsäure HR 200

Silica / Silice

450 nm

Method(e) / Método

5341

5–100 mg/L Si

5342

10–200 mg/L SiO₂

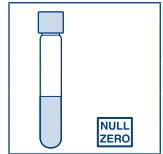

Probe / Sample
Echantillon
Muestra



1
Küvette spülen
Rinse test tube
Rincer l'éprouvette
Lavar el tubo

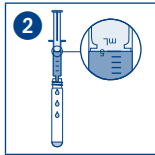

2
5 mL Probe
Sample
Echantillon
Muestra

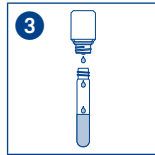

3
5 ∆ SiO₂-1



4
Schütteln
Shake
Agiter
Agitar

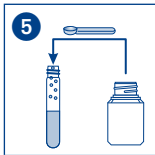

5
1 ∆ SiO₂-2



6
Schütteln
Shake
Agiter
Agitar



7
2'00 min

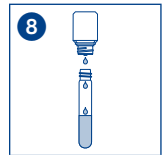

8
5 ∆ SiO₂-3



9
Schütteln
Shake
Agiter
Agitar



10
Säubern
Clean
Nettoyer
Limpiar



11
2'00 min



12
Messung
Measurement
Mesure
Medición

Meerwasser
Sea water
Eau de mer
Agua de mar



visicolor[®] ECO Chlor 1 (frei)
Chlorine (free)/Chlore (libre)/Cloro (libre)

530 nm

Method(e) / Método

5351

0.05–2.00 mg/L Cl₂

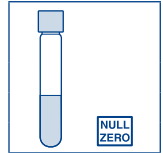

Probe / Sample
 Echantillon
 Muestra



1
 Küvette spülen
 Rinse test tube
 Rincer l'éprouvette
 Lavar el tubo

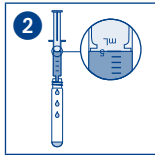

2
 5 mL Probe
 Sample
 Echantillon
 Muestra

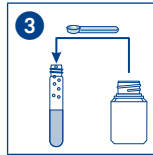

3
 1 Cl₂-1



4
 20 s Schütteln
 Shake
 Agiter
 Agitar

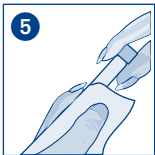

5
 Säubern
 Clean
 Nettoyer
 Limpiar

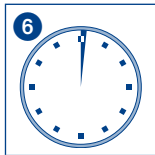

6
 1'00 min



7
 Messung
 Measurement
 Mesure
 Medición

Messtoleranzen:
 Measuring tolerances:
 Tolérance de mesure :
 Tolerancia de la medición:
 ± 0.10 mg/L Cl₂

Meerwasser
 Sea water
 Eau de mer
 Agua de mar



visicolor[®] ECO Chlor 1 (gesamt)
Chlorine (total) / Chlore (total) / Cloro (total)

530 nm

Method(e) / Método

5352

0.05–2.00 mg/L Cl₂

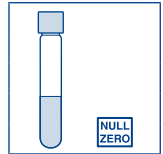

Probe / Sample
Echantillon
Muestra



1
Küvette spülen
Rinse test tube
Rincer l'éprouvette
Lavar el tubo

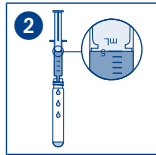

2
5 mL Probe
Sample
Echantillon
Muestra

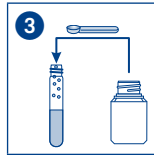

3
1 Cl₂-1



4
20 s Schütteln
Shake
Agiter
Agitar

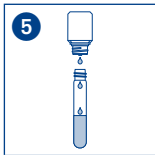

5
3 Cl₂-2



6
Schütteln
Shake
Agiter
Agitar



7
Säubern
Clean
Nettoyer
Limpiar

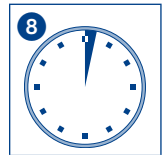

8
2'00 min



9
Messung
Measurement
Mesure
Medición

Messtoleranzen:
Measuring tolerances:
Tolérance de mesure :
Tolerancia de la medición:
± 0.10 mg/L Cl₂

Meerwasser
Sea water
Eau de mer
Agua de mar



visicolor[®] ECO Chlor 1 (gebunden)

Chlorine (combined)/Chlore (combiné)/Cloro (ligado)

530 nm

Method(e) / Método

5351 + 5353

0.05–2.00 mg/L Cl₂

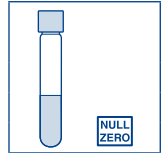

Probe / Sample
Echantillon
Muestra



1
Küvette spülen
Rinse test tube
Rincer l'éprouvette
Lavar el tubo

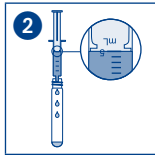

2 5 mL Probe
Sample
Echantillon
Muestra

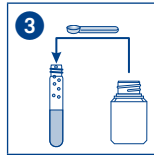

3 1 Cl₂-1



4 20 s Schütteln
Shake
Agiter
Agitar



5
Säubern
Clean
Nettoyer
Limpiar

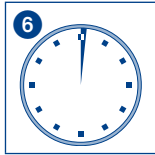

6 1'00 min



7
Messung
Measurement
Mesure
Medición



Method(e) 5353
Método 5353

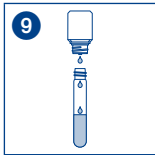

9 3 Cl₂-2



10
Schütteln
Shake
Agiter
Agitar

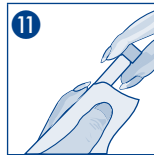

11
Säubern
Clean
Nettoyer
Limpiar

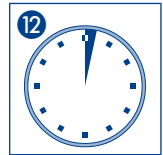

12 2'00 min



Messung
Measurement
Mesure
Medición

Messtoleranzen:
Measuring tolerances:
Tolérance de mesure :
Tolerancia de la medición:
± 0.10 mg/L Cl₂

Meerwasser
Sea water
Eau de mer
Agua de mar



visicolor® ECO Nitrat

Nitrate / Nitrato

450 nm

Method(e) / Método

5411

5412

1.0–14.0 mg/L NO₃-N

4–60 mg/L NO₃⁻

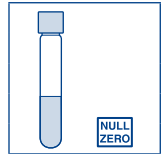

Probe / Sample
Echantillon
Muestra



1
Küvette spülen
Rinse test tube
Rincer l'éprouvette
Lavar el tubo

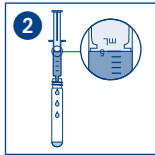

2
5 mL Probe
Sample
Echantillon
Muestra

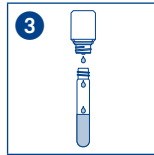

3
5 ∆ NO₃-1



4
Schütteln
Shake
Agiter
Agitar

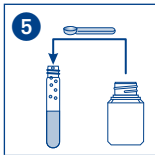

5
1 ∆ NO₃-2



6
1 min Kräftig schütteln
Shake well
Bien Agiter
Agitar intensamente

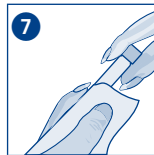

7
Säubern
Clean
Nettoyer
Limpiar

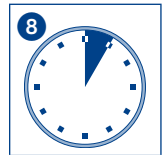

8
5'00 min



9
Messung
Measurement
Mesure
Medición

Messtoleranzen:
Measuring tolerances:
Tolérance de mesure :
Tolerancia de la medición:
± 5 mg/L NO₃⁻

Meerwasser
Sea water
Eau de mer
Agua de mar



visicolor[®] ECO pH 6.0–8.2

450/530 nm

Method(e) / Método

5701

6.10–8.40 pH

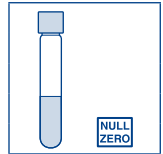

Probe / Sample
Echantillon
Muestra

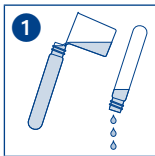

1
Küvette spülen
Rinse test tube
Rincer l'éprouvette
Lavar el tubo

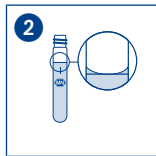

2
10 mL Probe
Sample
Echantillon
Muestra

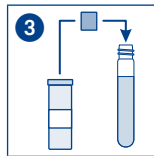

3
1 NANOFIX pH



4
Schütteln
Shake
Agiter
Agitar

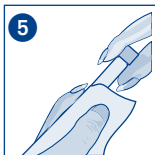

5
Säubern
Clean
Nettoyer
Limpiar

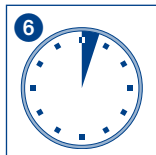

6
3'00 min



7
Messung
Measurement
Mesure
Medición

Messtoleranzen:
Measuring tolerances:
Tolérance de mesure :
Tolerancia de la medición:
± 0.05 pH

Meerwasser
Sea water
Eau de mer
Agua de mar



visocolor® ECO Phosphat *

Phosphate / Fosfato

660 nm

Method(e) / Método

5841

0.2–5.0 mg/L PO₄³⁻

5842

0.6–15.0 mg/L PO₄³⁻

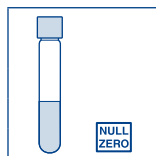

Probe / Sample
Echantillon
Muestra

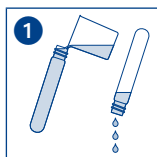

1
Küvette spülen
Rinse test tube
Rincer l'éprouvette
Lavar el tubo

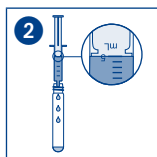

2
5 mL Probe
Sample
Echantillon
Muestra

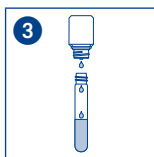

3
6 ∆ PO₄³⁻-1



4
Schütteln
Shake
Agiter
Agitar

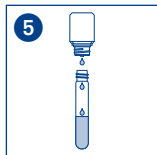

5
6 ∆ PO₄³⁻-2



6
Schütteln
Shake
Agiter
Agitar

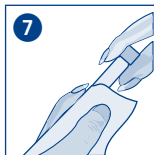

7
Säubern
Clean
Nettoyer
Limpiar

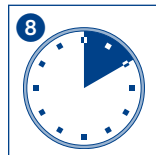

8
10'00 min



9
Messung
Measurement
Mesure
Medición

* Bei Anwendung in der Bodenanalytik mit der Extraktionslösung B (CAL), bitte die Hinweise des „VISOCOLOR® Bodenkoffer“-Handbuchs REF 914 602 in Kapitel 3.7 beachten (Verdünnung 1+4).

* For use in soil analysis with the extraction solution B (CAL), please consider the instructions from the „VISOCOLOR® Reagent case for soil analysis“ handbook REF 914 602 in chapter 3.7 (dilution 1+4).

* Pour l'utilisation dans le cadre de l'analyse du sol avec la solution d'extraction B (CAL), utiliser l'instruction de la « mallette d'analyse du sol VISOCOLOR® » manuel REF 914 602 chapitre 3.7 (dilution 1+4)

* Para aplicaciones en análisis de suelos con la disolución para extracción B (CAL), por favor considere las instrucciones del manual „VISOCOLOR® Maletín para análisis de suelos“ REF 914 602 capítulo 3.7 (dilución 1+4).

Messtoleranzen:
Measuring tolerances:
Tolérance de mesure :
Tolerancia de la medición:
± 0.1 mg/L PO₄

Meerwasser
Sea water
Eau de mer
Agua de mar



MACHERY-NAGEL

Your competent partner in analytical chemistry

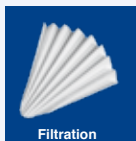

Filtration

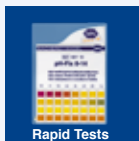

Rapid Tests



Water Analysis



Chromatography



Bioanalysis

Tradition and Modernity – 100 years experience

- Worldwide operating German company (founded 1911)
- Subsidiaries in France, Switzerland and USA
- Distributors in over 150 countries
- Development, production and sales of special products for water, environmental and food analysis, for biotechnology, chemical and pharmaceutical industry and medical diagnostics



**Investment in the future –
New building in Düren for Research & Development,
production and warehouse**

Service

- Technical support by our Customer Service Center
- Product-specific quality certificates and Material Safety Data Sheets
- Customized special products
- Easy ordering and short delivery times
- Large number of catalogs, flyer and product information – of course free of charge

Contact

Technical support and customer service

Filtration, Rapid Tests, Water Analysis: +49 24 21 969-161
+49 24 21 969-138
+49 24 21 969-190
+49 24 21 969-174
+49 24 21 969-340
+49 24 21 969-187
csc@mn-net.com

www.mn-net.com

MACHERY-NAGEL



MACHERY-NAGEL GmbH & Co. KG · Neumann-Neander-Str. 6-8 · 52355 Düren · Germany

Germany
and international:

Tel.: +49 24 21 969-0
Fax: +49 24 21 969-199
E-mail: info@mn-net.com

Switzerland:
MACHERY-NAGEL AG

Tel.: +41 62 388 55 00
Fax: +41 62 388 55 05
E-mail: sales-ch@mn-net.com

France:
MACHERY-NAGEL EURL

Tel.: +33 388 68 22 68
Fax: +33 388 51 76 88
E-mail: sales-fr@mn-net.com

