

# visocolor® ECO Chlor 1 (frei) Chlorine (free)/Chlore (libre)/Cloro (libre)

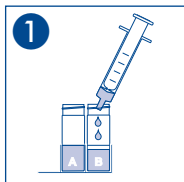

Messbereich / Range / Domaine de mesure / Rango  
0.1–2.0 mg/L Cl<sub>2</sub>

REF 931 035  
931 235



**1**  
2 x 5 mL Probe  
Sample  
Echantillon  
Muestra



**2**  
1 Cl<sub>2</sub>-1

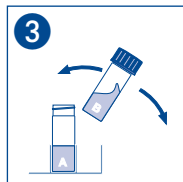

**3**  
20 s Schütteln  
Shake  
Agiter  
Agitar

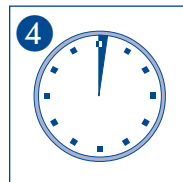

**4**  
1'00 min

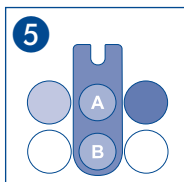

**5**  
Messung  
Measurement  
Mesure  
Medición



Meerwasser  
Sea water  
Eau de mer  
Agua de mar

# visocolor® ECO Chlor 1 (gesamt) Chlorine (total)/Chlore (totale)/Cloro (total)

Messbereich / Range / Domaine de mesure / Rango  
0.1–2.0 mg/L Cl<sub>2</sub>

REF 931 035  
931 235

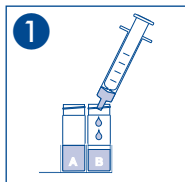

**2 x 5 mL** Probe  
Sample  
Echantillon  
Muestra

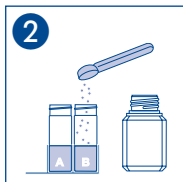

**1** Cl<sub>2</sub>-1

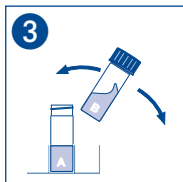

**20 s** Schütteln  
Shake  
Agiter  
Agitar

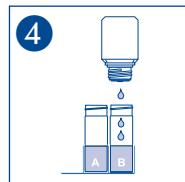

**3** Cl<sub>2</sub>-2

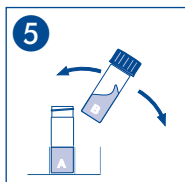

Schütteln  
Shake  
Agiter  
Agitar

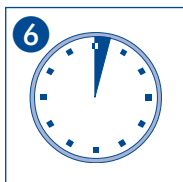

**2'00 min**

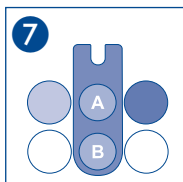

Messung  
Measurement  
Mesure  
Medición



Meerwasser  
Sea water  
Eau de mer  
Agua de mar